

## AUXILIARY DRIVING LIGHTS (CROSS ROADS LE)

### Removal

1. Remove bolt (A) securing turn signal assembly and driving lamp mounting bracket to light bar.

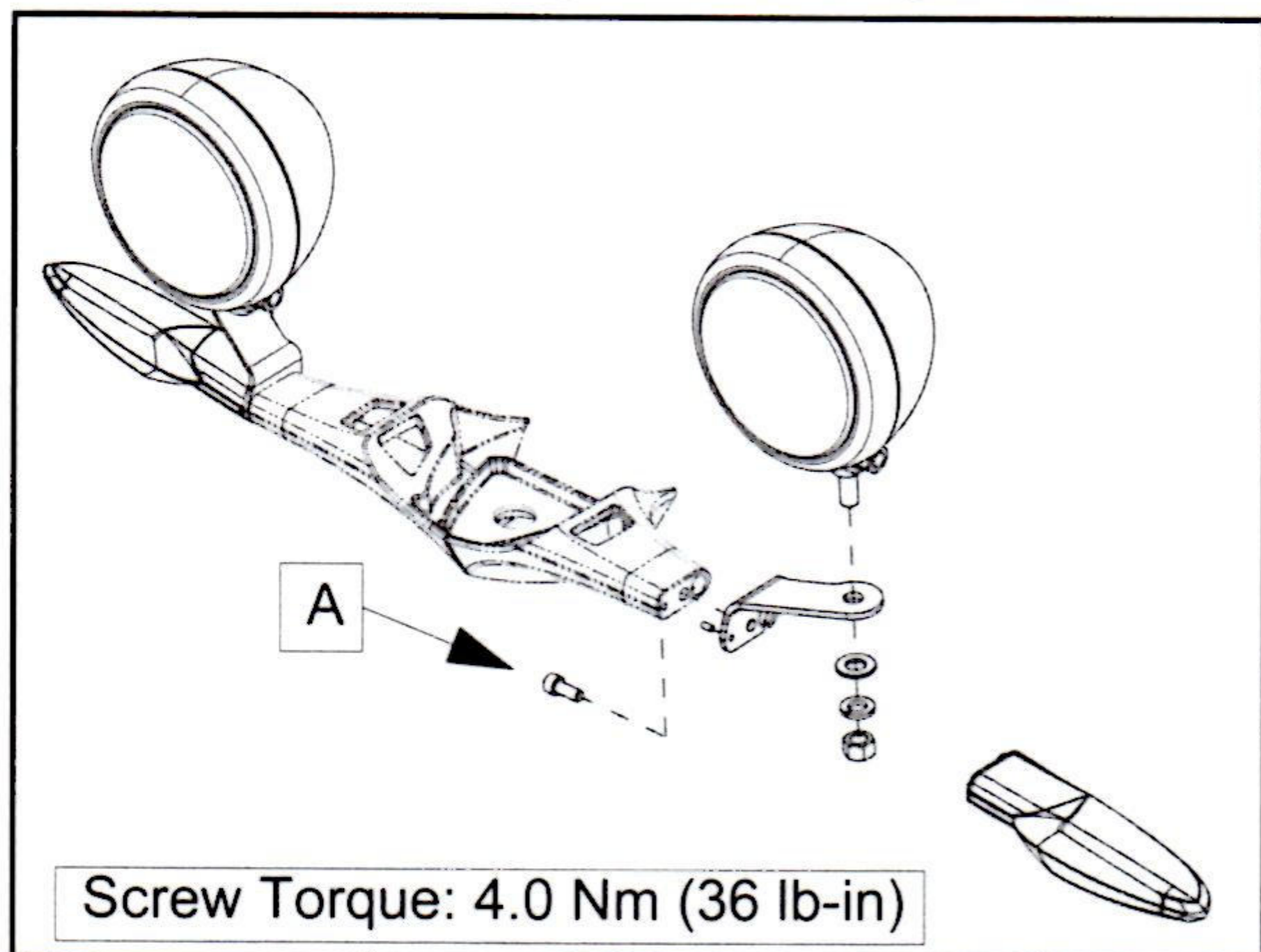

2. Remove driving lamp / mount assembly.

### Installation

3. Reverse procedure to install. **Torque screws to 4.0 Nm (36 lb-in).**

## SPEAKER GRILL

### Removal

1. Using body tool, pry outward carefully in area shown to release one edge of grill then pull straight outward to release all tabs. Do not bend or rotate the grill during removal.



## FRONT FAIRING - UPPER (CROSS COUNTRY)

### Removal

1. Remove headlamp bezel and headlamp (page 3.9).
2. Remove both speaker grills (page 3.14).
3. Remove screws indicated below.

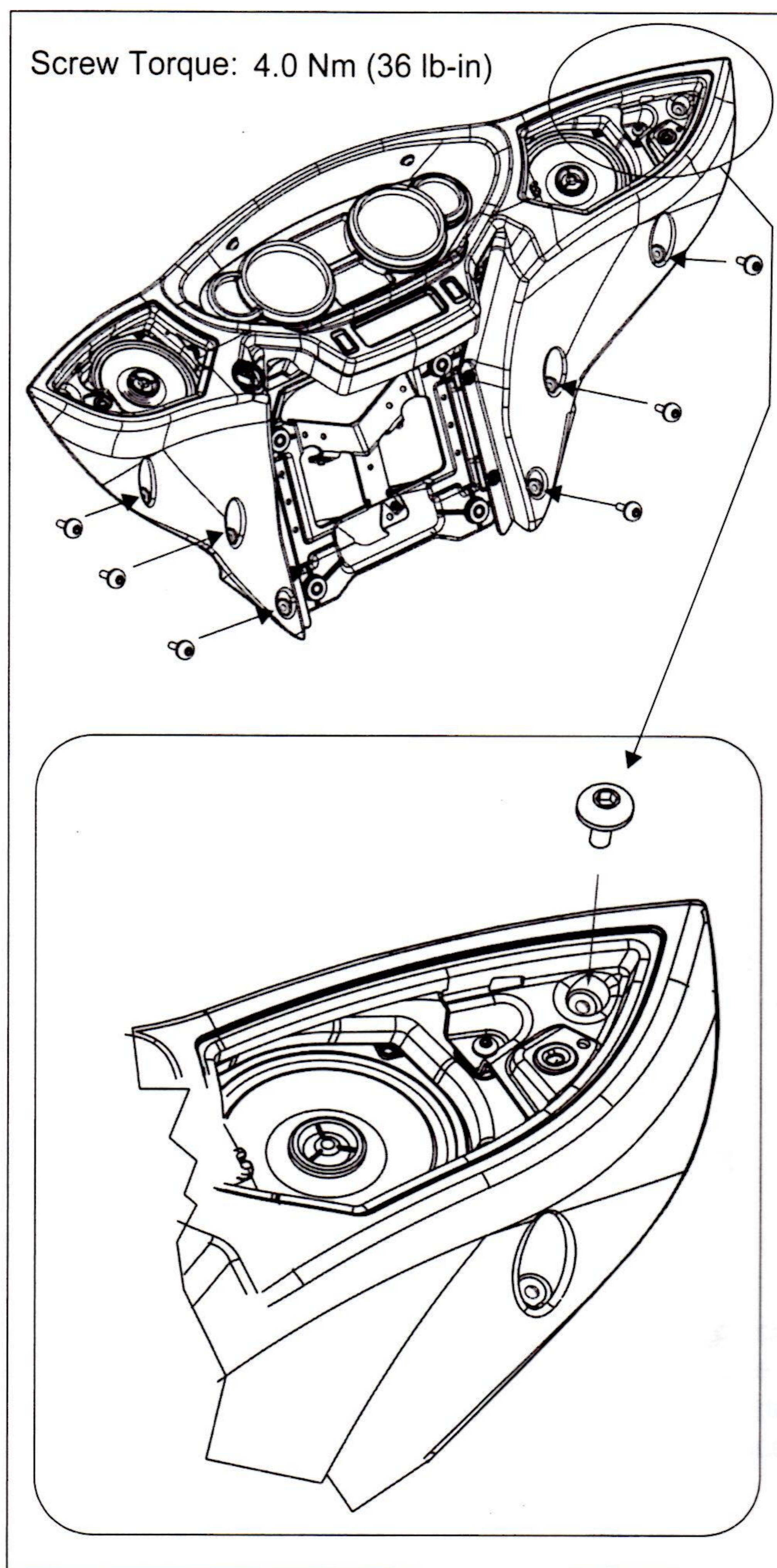

4. Grasp fairing by the upper edge (near the visor) and in the lower center headlight opening. Pull forward on the bottom edge and then the top to remove.
5. Disconnect turn signal wires (push small white tab),

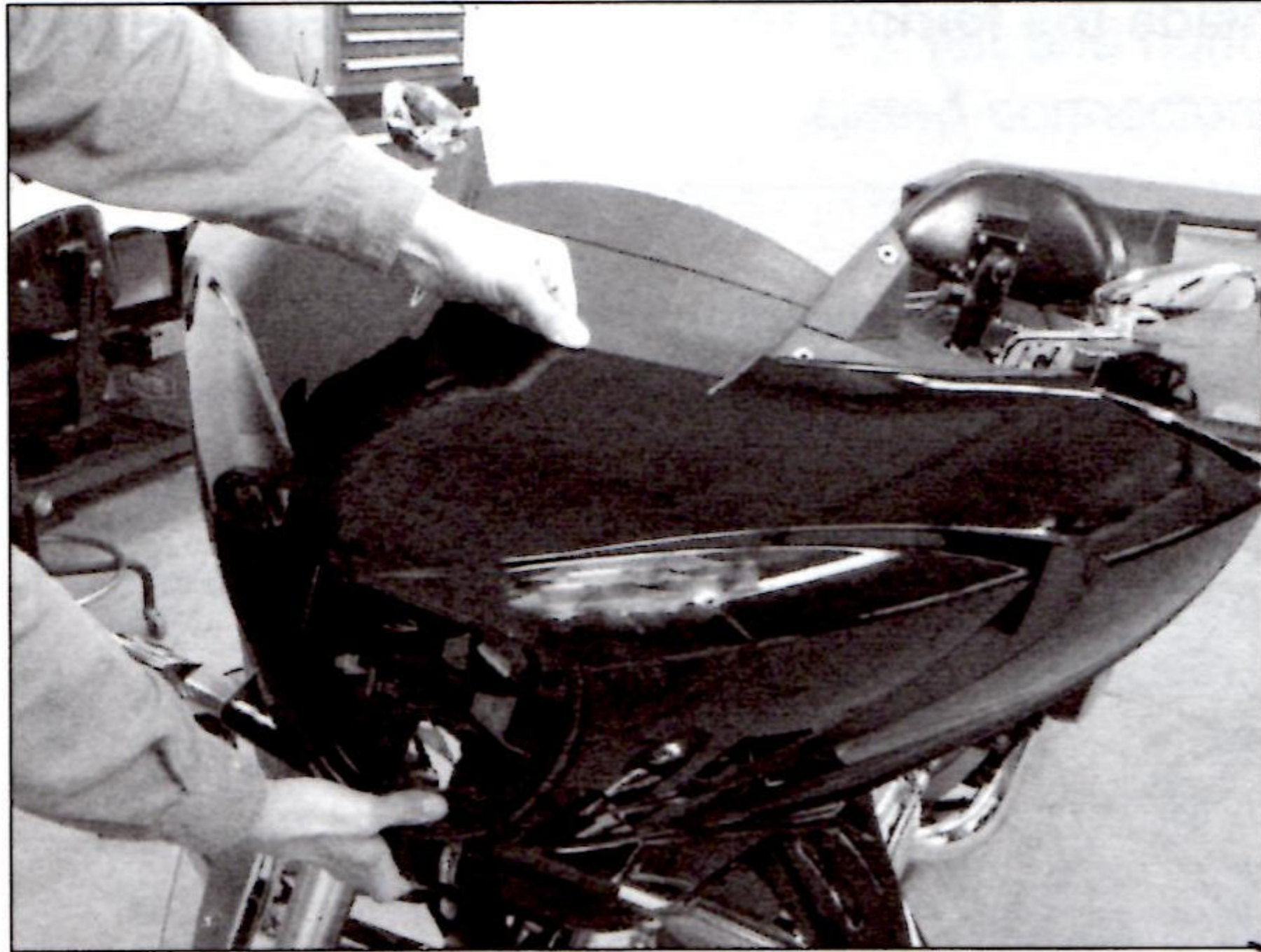

*BLACK WIRE, HEATED GRIPS (3 WIRE),  
Installation  
AUTO LIGHTS (2 WIRES)*

1. Place the two tabs (A) on the fairing into the slots on the front support.
2. Be sure wires are not trapped in area (B).
3. Pull the fairing down and forward in area (C) to snap fairing alignment pin into the hole in the front support.

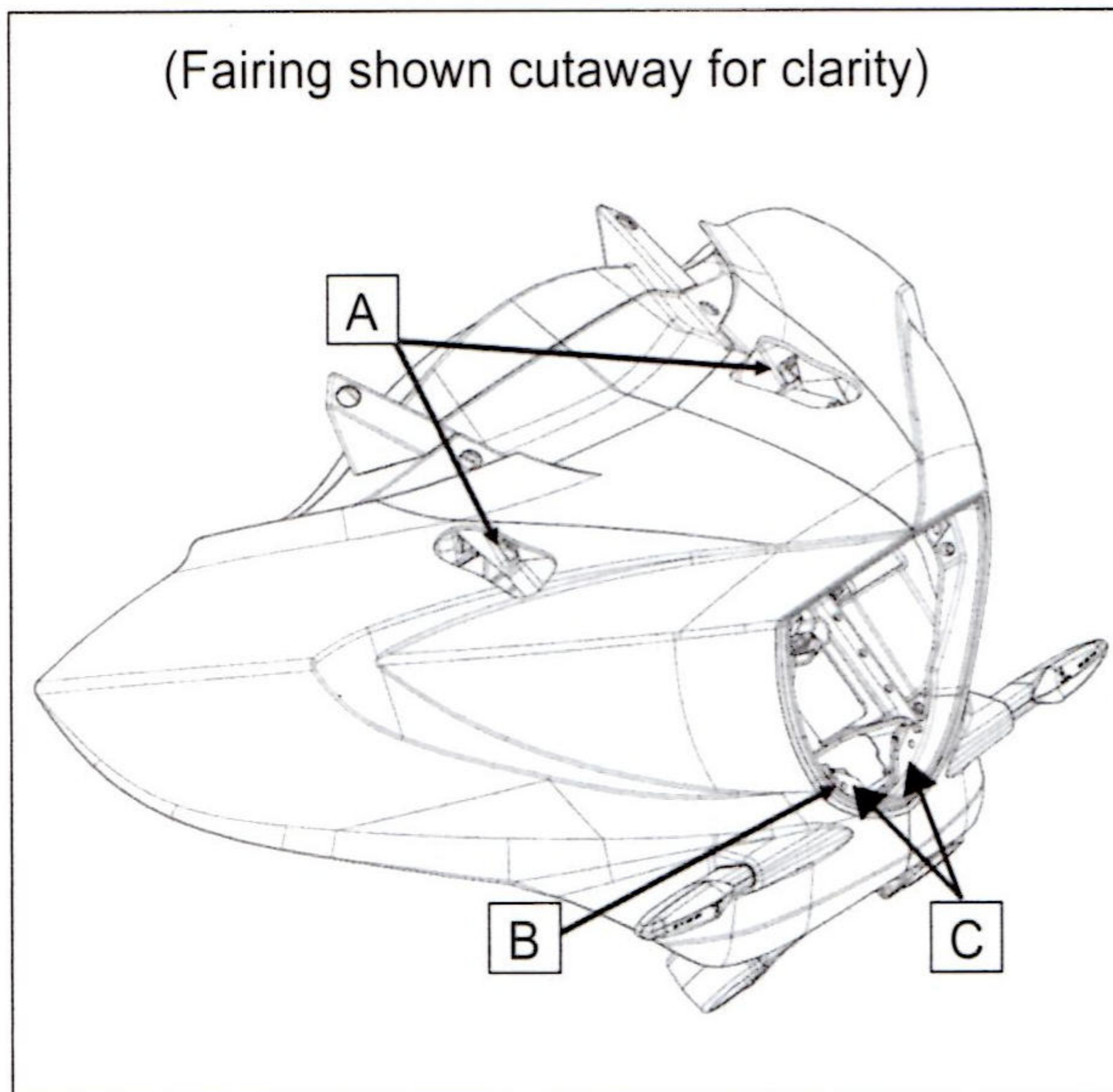

4. Install screws and torque to 4.0 Nm (36 lb-in).
5. Install speaker grills (page 3.14), headlamp (page 3.9), headlamp bezel (page 3.9), and windshield (page 3.6, if removed).

**DASH PANEL**

Also refer to Fairing Assembly Views page 3.16.

1. Remove fairing (page 3.14) and windshield (page 3.6).
2. Remove (6) screws indicated below.

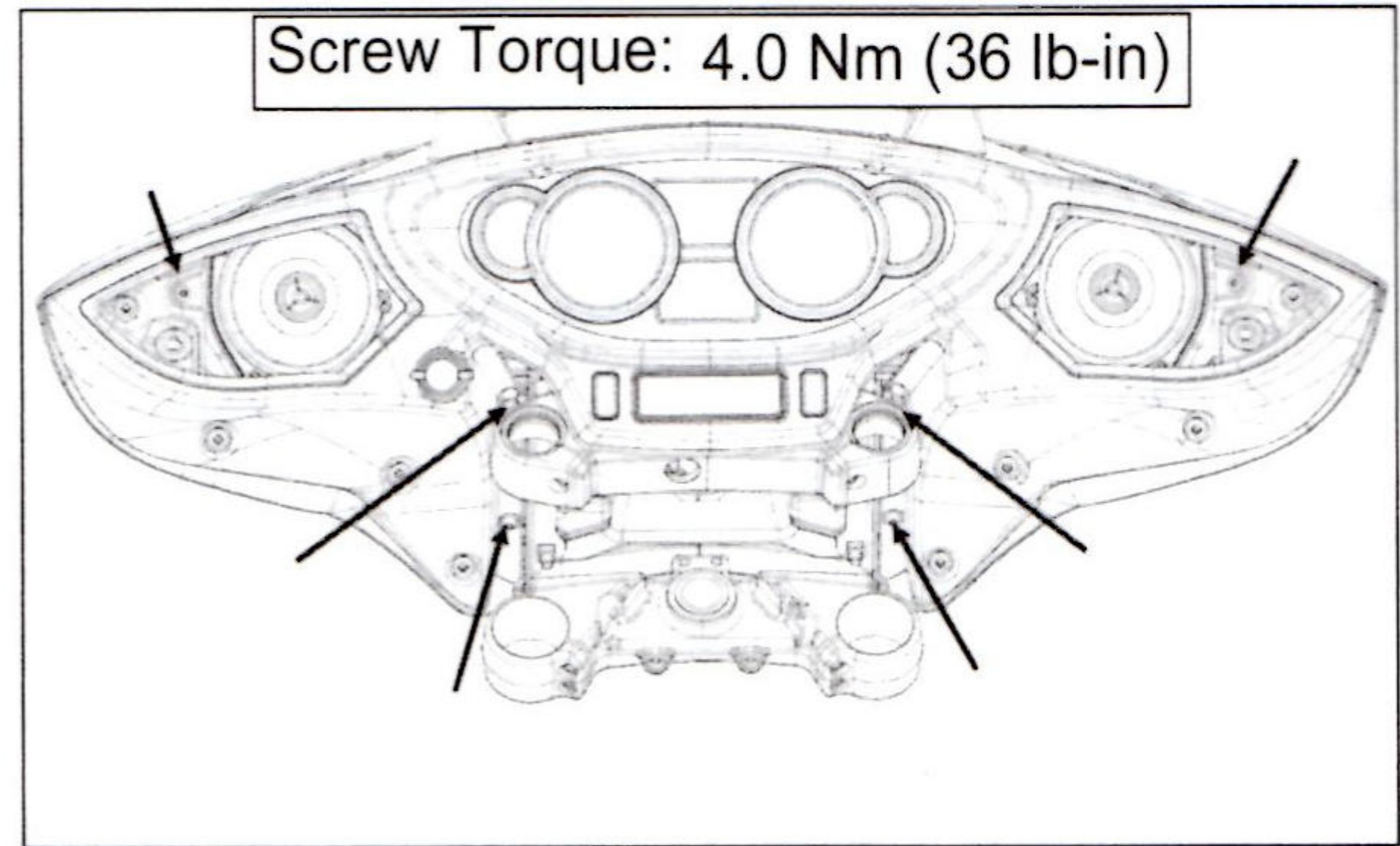

3. Remove (2) screws above the instruments.

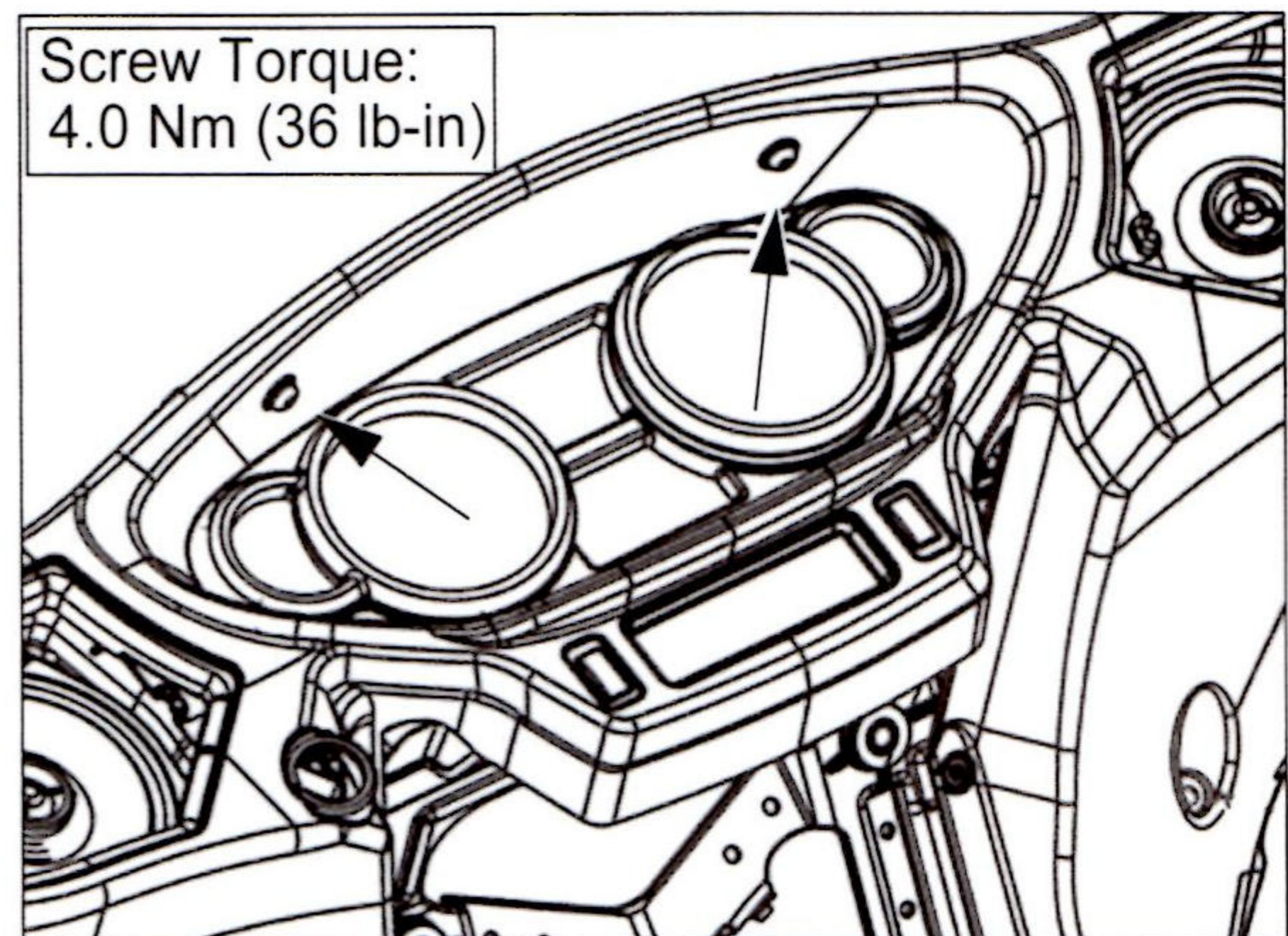

4. Remove (2) *SHORT* screws located underneath the information display area.

